

ZOOM Nitro™ & NEXEO | HDX™ Pre-Installation Checklist

The NEXEO | HDX and ZOOM Nitro systems are powerful, industry-leading communication systems that maximize productivity and profits. The NEXEO | HDX and ZOOM Nitro systems may only be installed in a correctly configured site. The following requirements must be in place before installation begins to ensure trouble-free system functionality for many years to come.

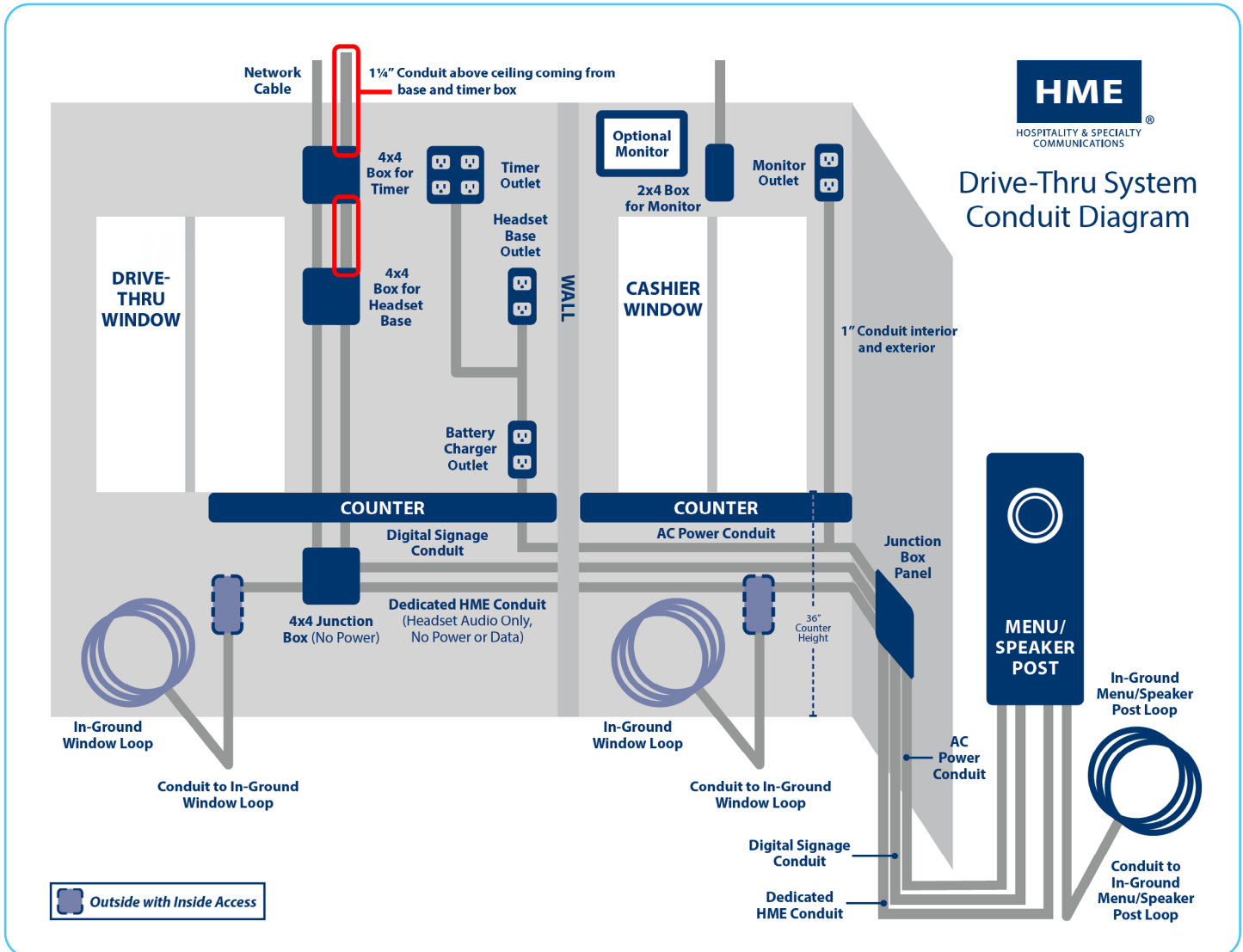

1. Dedicated Conduits:

- 1 1/4" Inner diameter recommended for stub out above ceiling from the base and timer box.
- 1" Inner diameter conduit for all other internal and external runs. Local/state regulations may vary.
- Please see the diagram above for a map of the conduit layout.
- Straight runs are recommended.
- No 90° angles in run.
- No other wiring or cable may share the HME conduit connected to speaker post.
- If store is multi lane, each lane will need its own dedicated conduit.

2. Permanent Power & Outlets:

- a. Electricity from the local utility must be connected at the site and turned on before installation of any HME equipment. Voltage, amperage, and outlets may vary by region or franchise.
- b. No extension cords are to be used between the electrical outlets and HME equipment.
- c. Please note the layout, number, and locations of required electrical outlets on the diagram above.

3. Finished Walls:

- a. The walls where the HME equipment and conduits will be installed must be finished and painted with the final coat.

4. Network:

- a. A standard rack for mounting HME equipment must be provided in a permanent location before installation.
- b. Network must be fully operational.
- c. Network switch must be installed.
- d. Open ports must be available for all HME equipment to be installed.

5. Detection Loops:

- a. For new or remodeled restaurants, prefabricated loops that will be installed by a contractor, must be in place, prior to HME equipment installation.
- b. Installation of saw-cut loops must be completed for HME equipment to operate for established stores without existing loops.
- c. Loop leads should be a minimum of 18".
- d. The loops must fall between 100-150 Microhenries and approximately 1 ohm.
- e. HME Loops are strongly recommended for optimal functionality of HME systems.

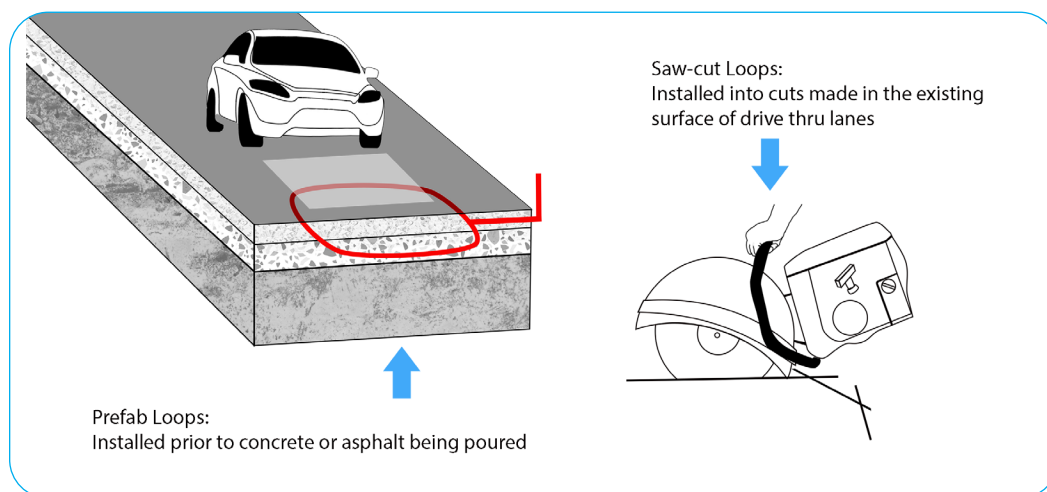

6. Drive Thru Lane Surface:

- a. Lane concrete or asphalt must be poured and completely cured prior to HME equipment installation. (3-7 days)
- b. Drive-Thru lane must be 100% clear of tools and materials to facilitate HME equipment installation.

7. Speaker Posts/ Order Confirmation Board/ Menu Board:

- a. Speaker Post, Speaker and Microphone location must be completely installed including conduit described above before installing HME equipment.
- b. Confirm dimensions of Speaker Post, Speaker and Microphone location will effectively accommodate HME speaker components. To confirm dimensions of the components, refer to the User Manual here:
<https://www.hme.com/qsr/support/drive-thru-user-manuals/>

8. Point-Of-Sale (POS) System:

- a. POS System and monitors must be completely installed prior to installation, to ensure visibility and prevent improper placement of HME equipment.

For help, call 800.848.4468 (options 1, 2, and 3) or email: support@hme.com

3 of 3

HME Training Portal

Find instructional videos, supporting documents, and other guides.

© 2024 HM Electronics, Inc. The HME logo and product names are trademarks or registered trademarks of HM Electronics, Inc. All rights reserved. 4.11.24

www.hme.com/training
Scan to Visit >

