

HME

®

AC50 Battery Charger

INSTALLATION INSTRUCTIONS

The AC50 Battery Charger can charge up to four batteries at the same time. Battery-status lights at charging ports tell you when batteries are charging or fully charged. Charging time is about 2.5 hours. Four storage ports are provided to store fully-charged batteries. The AC50 can be used on a desktop or wall mounted.



Figure 1. AC50 with battery in charging port

1. SETUP

1.1 Bracket Installation

The enclosed bracket angles the charger for the best visibility. Use of the bracket is recommended whether mounting the charger on the wall or using it on a desk top.

If you will use the AC50 on a desk top, follow the instructions in section 1.1.1 and then go on to section 1.2. If you will mount the AC50 on a wall, skip section 1.1.1 and go on to section 1.1.2.

1.1.1 Desk top use

Install the bracket on the charger as shown in Figure 3. The tabs on top and bottom of the bracket fit into the four rectangular holes on the back of the charger.

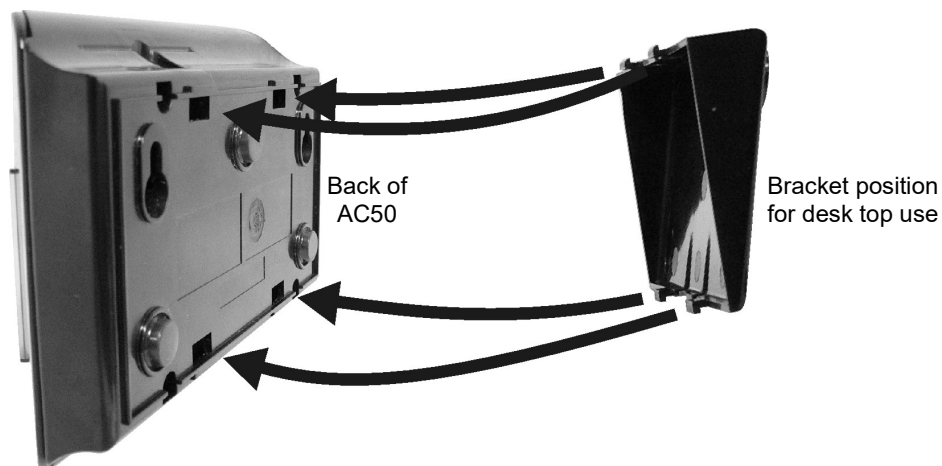

Figure 2. Install bracket on back of the AC50 for use on desk top

1.1.2 Wall Mounting

To mount the AC50 on the wall:

- Hold the bracket against the wall at the desired mounting location, a little below eye level and not more than 5.5 feet (1.68 meter) from an electrical outlet, away from splashing grease or water. Mark the wall through the two screw-mount holes on the bracket, shown in Figure 3.

NOTE: If flush mounting is preferred, the bracket will serve as a template for marking screw hole positions on the wall, since the positions of the screw-mount holes on the bracket are the same as those on the back of the charger.

- Drill two $\frac{3}{16}$ inch (4.76 mm) holes in the wall at the marked spots.
- Insert the two enclosed #6 screw anchors into the holes.
- Screw the two enclosed screws into the anchors, leaving the screw heads $\frac{1}{8}$ inch (3.2 mm) away from the wall.
- Mount the charger on the wall by placing the holes in the bracket (or the holes on the back of the charger for flush mounting), shown in Figures 3 and 4, over the two screws on the wall and then sliding the charger downward to secure it in place.

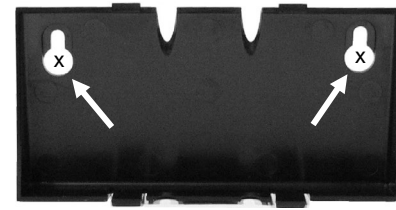

Figure 3. Screw-mount holes on bracket

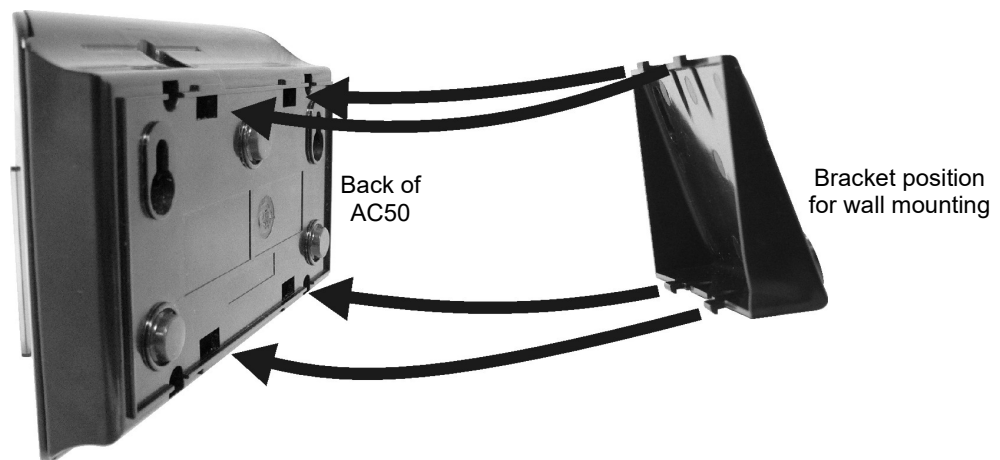

Figure 4. Install bracket on back of the AC50 for wall mounting

1.2

Power Connection & Specifications

AC Power Adapter: Only use the approved external power adapter provided with the AC50 Battery Charger.



Figure 5. +5VDC power adapter for use in the United States



Figure 6. Plug adapter cord into AC50

Plug the cord from the +5 V $\overline{\text{DC}}$ power adapter shown in Figure 5, into the top of the AC50 as shown in Figure 6, and then plug the adapter into the electrical outlet.

INTERNATIONAL POWER ADAPTER

An international power adapter is provided with the AC50 for use in countries outside the United States. Install the necessary plug on the adapter as shown in Figure 8.

Plug the adapter cord into the AC50 battery charger as shown in figure 6, and then plug the power adapter into an electrical outlet.



Figure 7. International adapter plugs

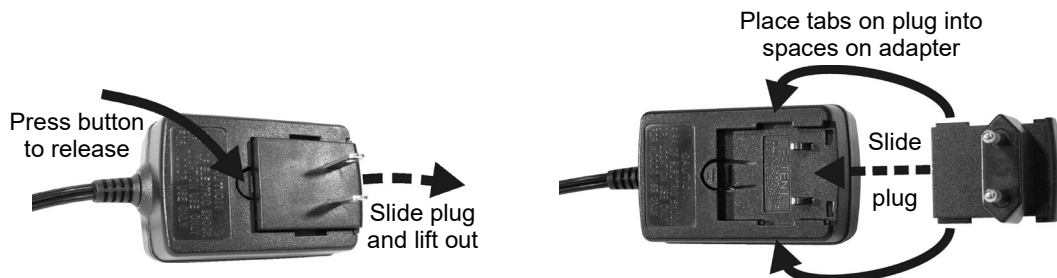

Figure 8. Changing plug in international power adapter



AC50 Input Rating: 5 V $\overline{\text{DC}}$, 2.25 A

Output Rating: 4.2 V $\overline{\text{DC}}$, 3 A



HME BAT50 Rating: 3.7 V $\overline{\text{DC}}$, 720 mAh

2. OPERATION

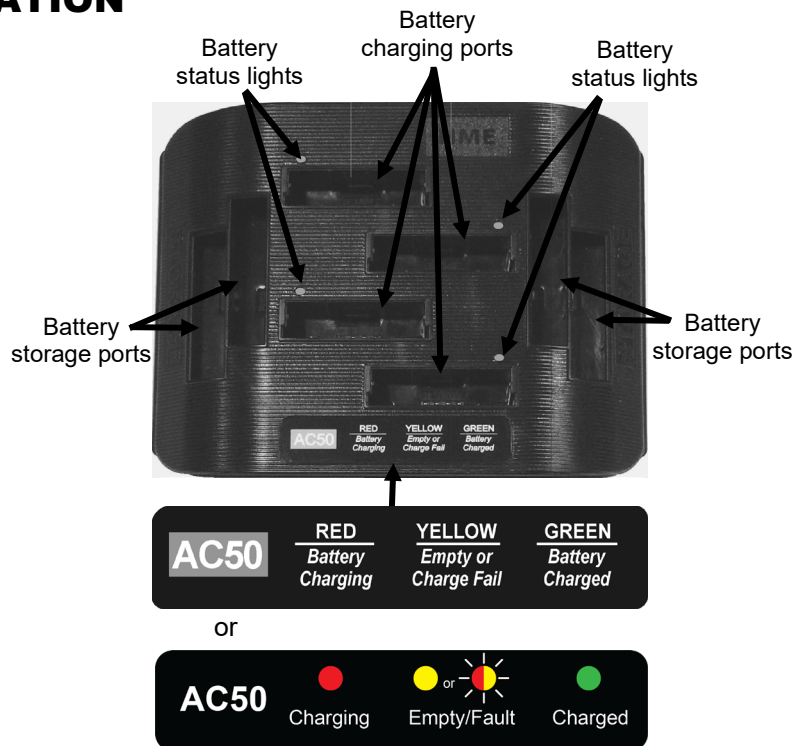

Figure 9. AC50 front panel features and battery status guide

Insert up to four batteries in the charging ports at a time. The batteries can only go into the charging ports one way. If they do not go in easily, turn them around **DO NOT force them**. Push each battery down into a port until it snaps in place, to be sure it makes full contact.

The battery status lights indicate the charging status, as shown on the battery status guide at the bottom of the AC50 front panel. When a battery charging port is empty, its status light will be yellow. When you place a battery in a port for charging, its status light will turn red. When a battery is fully charged, its status light will turn green. Install fully charged batteries in headsets or store them in the AC50 storage ports until they are needed.

If a battery is in a charging port and its status light is a steady yellow or flashing yellow/red, the charge failed (flashing activity only occurs on chargers with the second label). If this happens:

- Be sure the battery is pushed all the way into the port until it snaps in place to make contact.
- Try charging it in a different port. If it charges this time, the first charging port may be defective. If the battery does not charge in the second port, replace it with another battery.

For technical support in the USA, call 800-848-4468. Outside the USA, call your HME dealer.

Waste Electrical and Electronic Equipment (WEEE)

The European Union (EU) WEEE Directive (2012/19/EU) places an obligation on producers (manufacturers, distributors and/or retailers) to take-back electronic products at the end of their useful life. The WEEE Directive covers most HME products being sold into the EU as of August 13, 2005. Manufacturers, distributors and retailers are obliged to finance the costs of recovery from municipal collection points, reuse, and recycling of specified percentages per the WEEE requirements.



Instructions for Disposal of WEEE by Users in the European Union

The symbol shown below is on the product or on its packaging which indicates that this product was put on the market after August 13, 2005 and must not be disposed of with other waste. Instead, it is the user's responsibility to dispose of the user's waste equipment by handing it over to a designated collection point for the recycling of WEEE. The separate collection and recycling of waste equipment at the time of disposal will help to conserve natural resources and ensure that it is recycled in a manner that protects human health and the environment. For more information about where you can drop off your waste equipment for recycling, please contact your local authority, your household waste disposal service or the seller from whom you purchased the product.

Taiwan RoHS Declaration

Equipment name: Battery Charger			Type designation (Type), Model : AC50			
Unit	Restricted substances and its chemical symbols					
	Lead (Pb)	Mercury (Hg)	Cadmium (Cd)	Hexavalent chromium (Cr ⁺⁶)	Polybrominated biphenyls (PBB)	Polybrominated diphenyl ethers (PBDE)
PCB	—	○	○	○	○	○
Plastic Housing	—	○	○	○	○	○
Labels	○	○	○	○	○	○
Power Supply	○	○	○	○	○	○
<p>Note 1: “Exceeding 0.1 wt %” and “exceeding 0.01%” indicate that the percentage content of the restricted substance exceeds the reference percentage value of presence condition.</p> <p>Note 2: “○” indicates that the percentage content of the restricted substance does not exceed the percentage of reference value of presence.</p> <p>Note 3: The “—” indicates that the restricted substance corresponds to the exemption.</p>						



R45131
RoHS

Taiwan (BSMI) User Warning:

This is a Class A information technology product that may cause radio frequency interference when used in a residential environment. Under such circumstances, the user may be requested to take appropriate countermeasures.

General Battery Safety Instructions for Battery Models: BAT50, BAT60, BAT41

BATXX batteries are specifically designed only for use with product(s) offered by:
HM Electronics Inc. (HME)
Clear-Com LLC, an HME Company

SAFETY PRECAUTIONS

To ensure the safety and reliability of your Battery, follow the guidelines in this section.

Using the Battery



WARNING!

Do Not Abuse/Modify Battery Packs

Lithium-ion cells and battery packs may get hot, explode or ignite and cause serious injury if modified or abused.

Follow the safety instructions below:

- Do not place the battery in fire or heat the battery.
- Do not connect the battery backward, so the polarity is reversed.
- Do not connect the positive terminal and negative terminal of the battery to each other with any metal object (such as a wire).
- Do not carry or store the battery together with necklaces, hairpins or other metal objects.
- Do not pierce the battery with nails, strike the battery with a hammer, step on the battery or otherwise subject it to strong impacts or shocks.
- Do not solder directly onto the battery.
- Do not expose the battery to water or salt water, or allow the battery to get wet.
- Do not disassemble or modify the battery. The battery contains safety and protection devices which, if damaged, may cause the battery to generate heat, explode or ignite.
- The protection circuit module provided with battery packs is not to be used as a substitute for a shutoff switch.
- Do not place the battery in or near fire, on stoves or in other high temperature locations.
- Do not place the battery in direct sunlight, or use or store the battery in cars in hot weather. Doing so may cause the battery to generate heat, explode or ignite. Using the battery in this manner may also result in a loss of performance or shortened life expectancy.

- When the battery is worn out, insulate the terminals with adhesive tape or a similar non-conducting material before disposal.
- Immediately discontinue use of the battery if, while using, charging, or storing the battery, the battery emits an unusual smell, feels hot, changes color or shape or appears abnormal in any other way.
- Do not place the battery in microwave ovens, high-pressure containers or on induction cookware.



WARNING!

In the event the battery leaks and the fluid gets into one's eye, do not rub the eye. Rinse well with water and immediately seek medical care. If left untreated, the battery fluid could cause damage to the eye.



WARNING!

If the device causes abnormal current to flow, it may cause the battery to become hot, explode, or ignite causing serious injury.

Charger Types

Your battery must only be charged with a HME/Clear-Com recommended charger. Any attempt to use other types of chargers may cause an explosive reaction, fire or chemical burns. Do not assume that the physical form of another battery qualifies the charger for use with the HME/Clear-Com 104G041LF battery.

Charging the Battery

Be sure to follow the warnings listed below while charging the battery. Failure to do so may cause the battery to become hot, explode or ignite and cause serious injury.

- Do not continue charging the battery if it does not recharge as specified HME/Clear-Com User Guide, under charging instructions.
- Do not attach the battery to an external charger, power supply plug or directly to a car's cigarette lighter.

Recycling the Battery

If your business or household does not have a battery recycling program, go to the following URL or copy and paste the following URL into your browser, then enter your zip code for a list of recycling centers: <http://earth911.com>